

## AXOR Starck

### Baton hand shower 2jet

Surfaces: Article Number: **28532300**



#### product features

- shower head size: 68 x 24 mm
- spray type: Rain, Mono
- spray type adjustment by turning spray disc
- spray disc surface: grey
- maximum flow rate at 3 bar: 16,2 l/min
- flow rate Mono spray (at 3 bar): 12,4 l/min
- flow rate Rain spray (at 3 bar): 16,2 l/min
- minimum flow pressure: 1 bar
- rinseable screen seal
- connection thread G ½
- connection dimension: DN15
- suitable for continuous flow water heaters

#### Technology



#### Certificates



#### Product image



#### Scale drawing

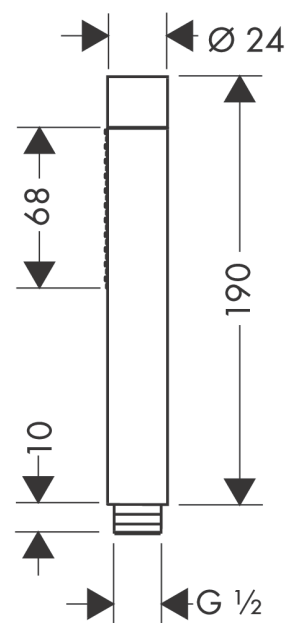

**AXOR Starck**

**Baton hand shower 2jet**

Surfaces: Article Number: **28532300**



## Flowchart

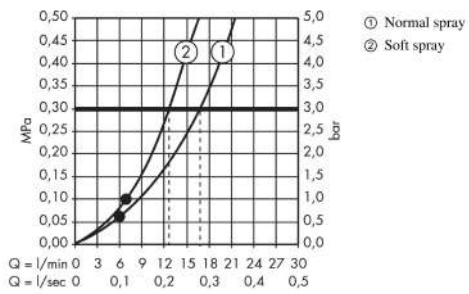

The consumption was measured in combination with the appropriate fittings (thermosta/mixer/ in-wall valve) to reflect actual application in practice.

**AXOR Starck**  
**Baton hand shower 2jet**  
Surfaces: Article Number: **28532300**



## Exploded Drawing

Year of production: >11/16

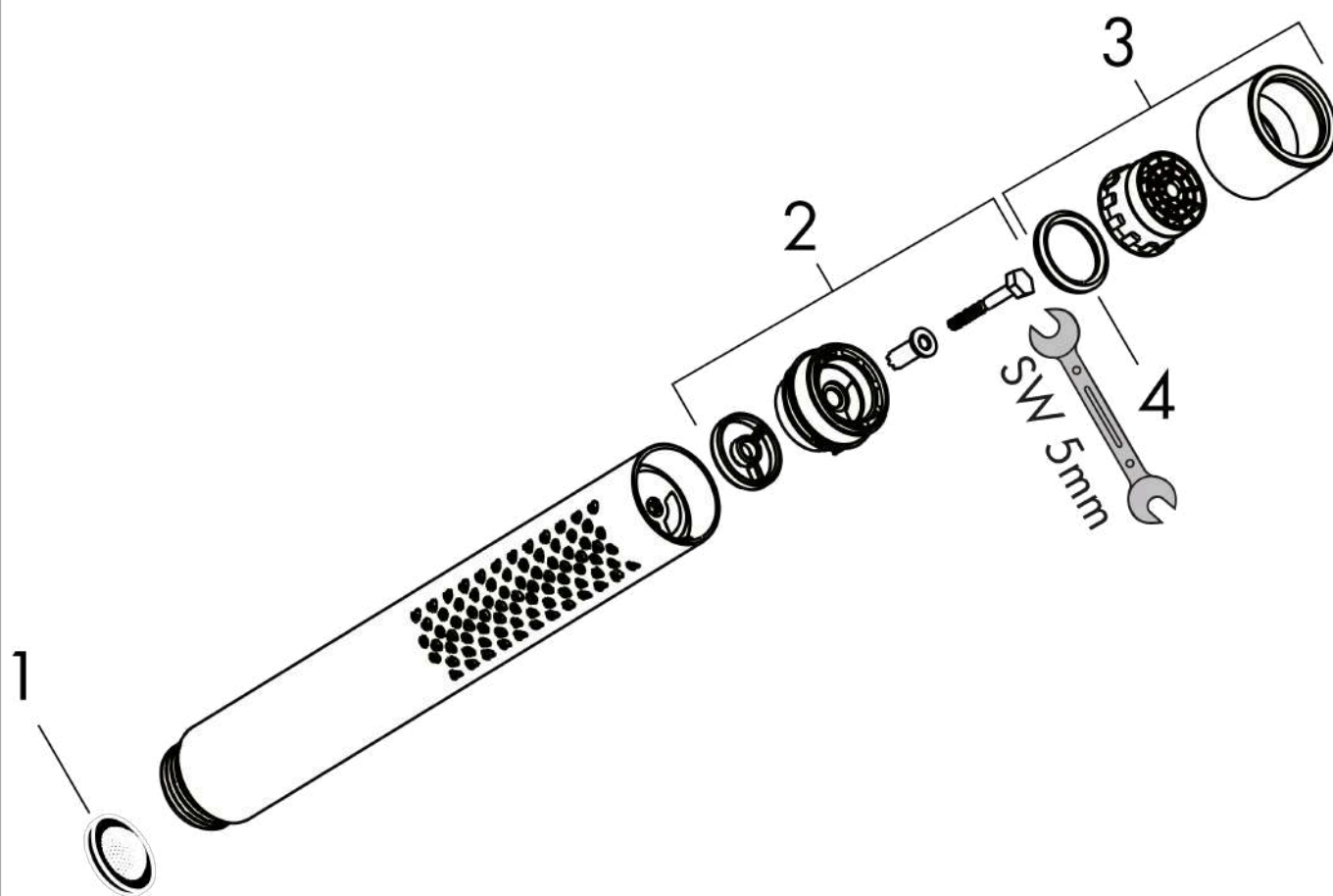

**AXOR Starck**  
**Baton hand shower 2jet**  
 Surfaces: Article Number: **28532300**



## Spare part list

Year of production: >11/16

Pos.		Article Number	PC	PU
1	filter packing	94246000	1	1
2	selector assy	95511000	4	1
3	spray former	95411300	59	1
4	O-Ring 14x2,5	98189000	1	1
a	flow-restrictor-set	92019000	2	1